

Hypertherm®

MAX200

MAX200 machine torch consumables

Mild steel

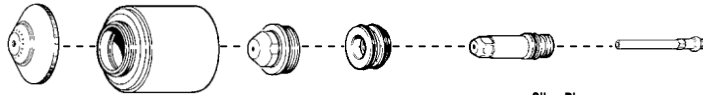

	Plasma gas	Shield	Retaining cap	Nozzle	Swirl ring	Electrode	SilverPlus electrode	Water tube
40 A	Air	020688	020423	020689	020613	220021	————	020963
100 A	O ₂	020448	120837	020616	020617	120547	————	020963
100 A	Air	020448	120837	020611	020607	120547	————	020963
200 A	N ₂	020424	120837	020608	020607	020415	————	020963
200 A	Air	020424	120837	020608	020607	220021	————	020963
200 A	O ₂	020424	120837	020605	020604	220021	220083	020963
200 A Gouging	Air	020485	020423	020615	020607	220021	————	020963
200 A Bevel	O ₂	120260	020423	120259	120833	120258	————	120257

Stainless steel

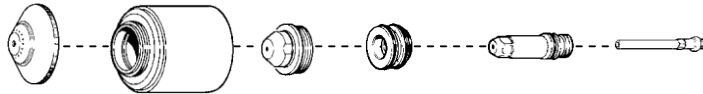

	Plasma gas	Shield	Retaining cap	Nozzle	Swirl ring	Electrode	Water tube
40 A	Air	020514	020423	020689	020613	220021	020963
100 A	Air	020448	120837	020611	020607	120547	020963
100 A	H35	020448	120837	020611	020607	020415	020963
200 A	Air	020424	120837	020608	020607	220021	020963
200 A	H35	020602	120837	020608	020607	020415	020963
200 A	N ₂	020424	120837	020608	020607	020415	020963
200 A Gouging	H35/N ₂	020485	020423	020615	020607	220021	020963

Aluminum

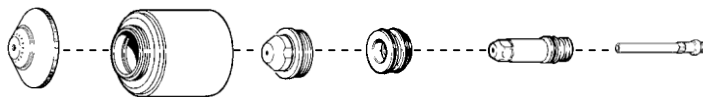

	Plasma gas	Shield	Retaining cap	Nozzle	Swirl ring	Electrode	Water tube
40 A	Air	020514	020423	020689	020613	220021	020963
100 A	Air	020448	120837	020611	020607	120547	020963
100 A	H35	020448	120837	020611	020607	020415	020963
200 A	Air	020448	120837	020608	020607	220021	020963
200 A	N ₂ /Air	020424	120837	020611	020607	020415	020963
200 A	N ₂ /CO ₂	020424	120837	020608	020607	020415	020963
200 A	H35/N ₂	020602	120837	020608	020607	020415	020963
200 A Gouging	H35/N ₂	020485	020423	020615	020607	220021	020963

Under water cutting

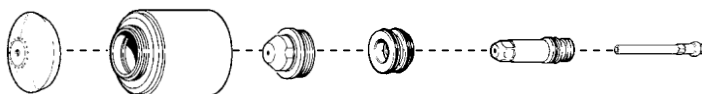

	Plasma gas	Shield	Retaining cap	Nozzle	Swirl ring	Electrode	Water tube
100 A	Air	020488	020423	020611	020607	120547	020963
100 A	O ₂	020448	020423	020616	020617	120547	020963
200 A	Air	020424	020423	020608	020607	220021	020963
200 A	O ₂	020424	020423	020605	020604	220021	020963
200 A	O ₂ (SS)	020424	020423	020608	020607	220021	020963
200 A	N ₂	020424	020423	020608	020607	020415	020963



128380 – Standard body – 2" sleeve



120356 – Stainless steel body

TECHNOLOGIES

Chambered swirl ring™

HyLife®

SilverPlus®

Vented shield™

Konstruktiv AB

Kungsgatan 37, 702 24 Örebro
www.konstruktiv.se

Tel: 019 - 12 5800
info@konstruktiv.se

* Do not use the water muffler when cutting with H35.

HyPro2000™ upgrade torch

For MAX200

Consumables

Air – Mild steel/Stainless steel/Aluminum

	Shield	Shield cap	Nozzle	Swirl ring	Electrode	Water tube
50 A	220532	220936	220890	220429	220528	220521
		220935 without tab				
130 A	220536	220936	220892	220488	220487	220521
		220935 without tab				
200 A	420045	220936	420044	220488	220937	220521
		220935 without tab				

O₂ – Mild steel

	Shield	Shield cap	Nozzle	Swirl ring	Electrode	Water tube
130 A	220536	220936	220892	220488	220487	220521
		220935 without tab				
200 A	420045	220936	420044	220488	220937	220521
		220935 without tab				

N₂ – Stainless steel/Aluminum

	Shield	Shield cap	Nozzle	Swirl ring	Electrode	Water tube
200 A	420045	220936	420044	220529	020415	220521
		220935 without tab				

Bold indicates new part numbers



HyPro2000 straight torch



HyPro2000 quick-disconnect torch

TECHNOLOGIES

- Chambered swirl ring
- Conical Flow™
- CoolFlow™
- LongLife®
- TrueFlow™
- Vented shield
- HyLife®



Kungsgatan 37, 702 24 Örebro
www.konstruktiv.se

Tel: 019 - 12 5800
info@konstruktiv.se

MAX200

PAC200 T/E hand torch consumables



Shielded consumables

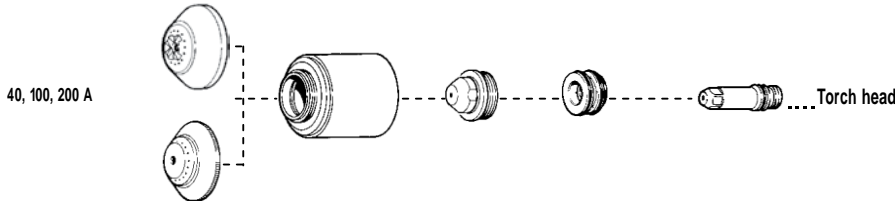

Metal	Plasma gas	Shield gas	Amps	Shield	Retaining cap	Nozzle	Swirl ring	Electrode
Mild steel/ stainless/ aluminum	Air	Air	40 A	020917	020915	020689	020613	220021
	Air	Air	100 A	020919	020915	020611	020607	120547
	Air	Air	200 A	020918	020915	020608	020607	220021
Stainless steel/ aluminum	Nitrogen (N ₂)	Carbon dioxide (CO ₂)	200 A	020918	020915	020608	020607	020415
	H35	Nitrogen (N ₂)	100 A	020919	020915	020611	020607	020415
Mild steel	Oxygen (O ₂)	Air	200 A	020918	020915	020608	020607	020415
	Oxygen (O ₂)	Air	100 A	020919	020915	020616	020617	220021
Stainless steel	H35	Air	200 A	020918	020915	020605	020604	220021
		Nitrogen (N ₂)	200 A	020920	020915	020608	020607	020415
Aluminum	H35	Nitrogen (N ₂)	200 A	020918	020915	020608	020607	020415



PAC200T hand torch

Gouging consumables

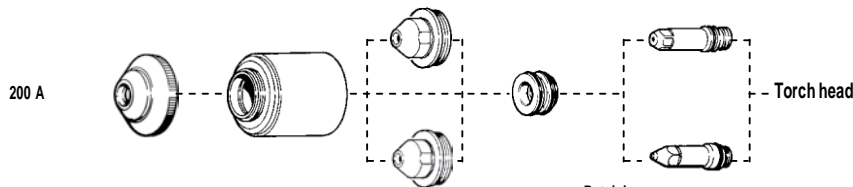

Metal	Plasma gas	Shield gas	Amps	Shield	Retaining cap	Nozzle	Swirl ring	Electrode
Mild steel	Air	Air	200 A	020891	020882	020615	020607	220021
	H35	Air	200 A	020891	020882	020934	020607	020933
Stainless steel/ aluminum	H35	Nitrogen (N ₂)	200 A	020891	020882	020934	020607	020933



PAC200E gouging torch



Kungsgatan 37, 702 24 Örebro
www.konstruktiv.se

Tel: 019 - 12 5800
info@konstruktiv.se

